

C281M/060060

Steel Recessed Access Cover, 600mm x 600mm clear opening, 80mm tray depth, Loading code M

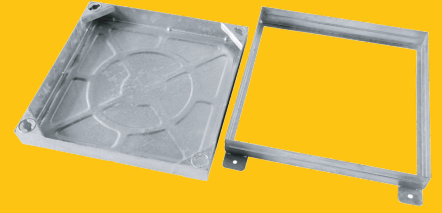

RANGE	OVERALL TOP OF FRAME	CLEAR OPENING (C X D)	FRAME DEPTH (E)	LOAD DUTY	WREKIN LOADING CODE
	750 mm x 640 mm	600 mm x 600 mm	85 mm	Light / medium duty	M

Key features

✓ Hot dipped galvanised for long life performance.

✓ Keyway lifting points.

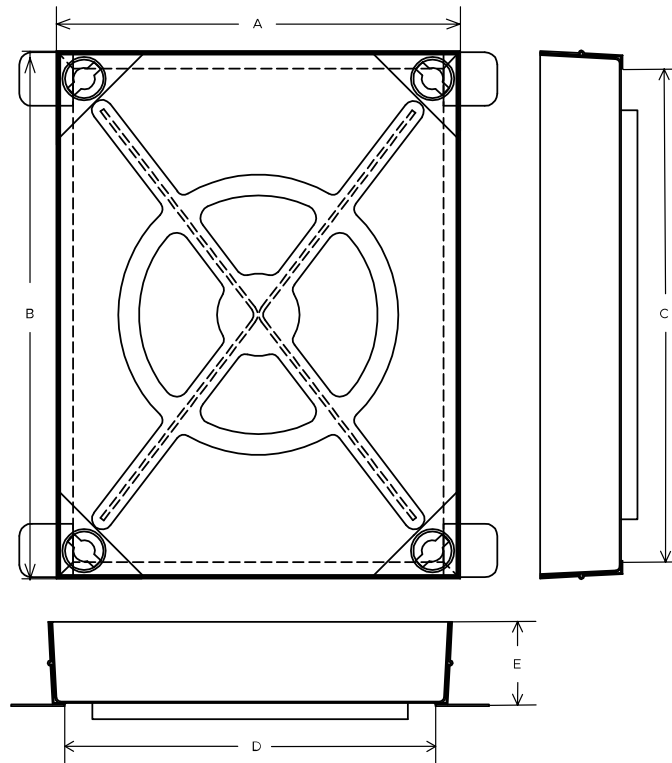

General information

Stock code	C281M/060060
Primary material	Steel
Category	Access cover
Flanges	4

Standards, classes and groupings

Wrekin loading code	M
---------------------	---

Steel-specific product data

Gross laden vehicle weight	10 tn
Load duty	Light / medium duty
Slow moving wheel load (pneumatic tyres)	2.5

Dimensions

Frame shape	Rectangular
Clear opening length (C)	600 mm
Clear opening width (D)	600 mm
Frame depth (E)	85 mm
Overall top of frame length (A)	750 mm
Overall top of frame width (B)	640 mm

1. Wrekin Products Ltd is continually seeking to improve our products and therefore reserves the right to alter product specifications without prior notice.
2. It is the responsibility of all users to satisfy themselves the above data is current.
3. Installation details are available on request.

